

1

1. First find the 2 'battery' symbols at the base of the spinning photo cube.

The location of these 2 symbols will indicate the side of the spinning cube where the battery compartment is located.

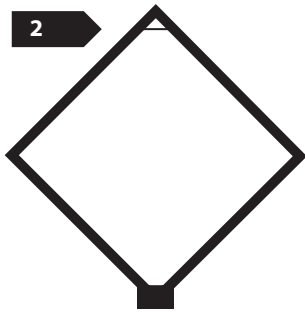

2

2. Find the catch on clear plastic cover, at the 'top' corner.

Using a dull instrument, lift the clear plastic cover away slightly, lightly bending the plastic cover.

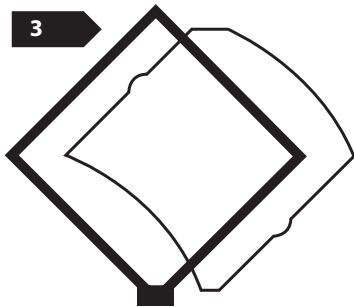

3

3. Remove the plastic cover by pulling the two tabs on opposite sides out of their slots.

Pay special attention to the orientation of the plastic cover, as you'll need to put it back the same way when re-assembling the spinning cube.

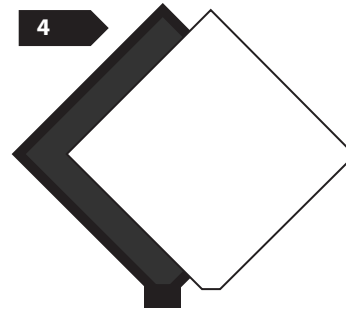

4

4. Remove the image insert carefully. Notice the angled corner at the 'bottom' edge of the image insert.

When replacing the image, be sure that the angled corner matches up with the 'bottom' edge of the spinning cube.

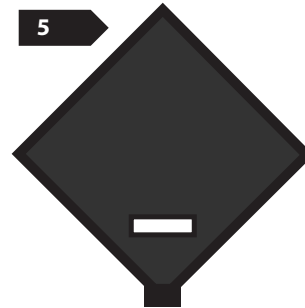

5

5. Behind the image insert you'll find the battery compartment.

Load a battery. The spinning mechanism at the base will begin to turn slowly as soon as the battery is inserted.

Perform steps 3-4 in reverse order to replace the image insert and plastic cover.

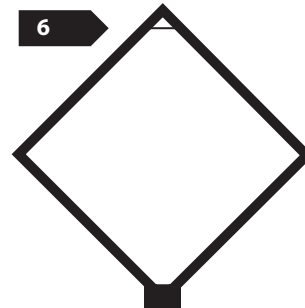

6

6. After reassembly, place spinning cube on a flat surface with the spinning mechanism level.

Once positioned properly, the spinning cube will spin indefinitely, until the battery needs to be replaced.

Do not leave discharged batteries in the spinning cube for long periods of time, as this will cause corrosion and damage.